

# TOSHIBA

**e-STUDIO6529A**

**e-STUDIO7529A**

**e-STUDIO9029A**

## Monochrome Multifunctional Printers

- Monochrome A3 print, scan, copy and fax systems with a speed of up to 90 pages per minute for today's business needs
- Advanced technology combined with ease-of-use for more efficiency in large-size workgroups requiring reliable document output and excellent image quality
- Easy, fast and precise digitalisation of paper originals with the integrated Dual Scan Document Feeder including a Double Feed Detection function, which can process up to 240 pages per minute



**TOGETHER  
INFORMATION**

## Cloud-ready and Secure

Today's new hybrid work environment has permanently changed demands on access to information: it must be available anywhere and anytime. Only then can organisations maintain maximum efficiency and productivity. Yet information also needs to be secure.

Toshiba's cloud-ready products and our team of experts provide the solutions you need to improve workflow and print with functionalities that are smarter and more convenient than ever before. We have implemented new features to increase productivity with the vision of Together Information – helping people and organisations share information more effectively through better products and solutions. In line with the needs of “new normal” workplaces, the series is equipped with functionalities that enable non-contact, non-face-to-face and remote work.

Based on the latest technological advances and security standards, we deliver end-to-end tailored solutions to help you seamlessly and securely navigate today's digital workplace. In addition, our multifunctional print (MFP) systems meet the highest environmental requirements. From consulting, cloud migration and fleet management to implementation and technical support, Toshiba is at your side.

Each of the models in the Toshiba e-STUDIO09029A series delivers high-quality monochrome documents precisely in line with the needs of large-size workgroups. All three multifunctional systems are equipped with state-of-the-art security features you can rely on and performance that will enhance productivity.

- > Advanced Toshiba e-BRIDGE Next controller technology ensures smooth integration and operation without compromising on document quality.
- > With a print speed of up to 90 pages per minute, exceptionally fast first-copy output and a paper capacity of up to 8,020 sheets, the e-STUDIO09029A series delivers reliable document output
- > Designed to support and enhance modern document workflows and simplify complex multi-step processes.

## Smart and Smooth

An intuitive 26 cm (10.1”) tablet-style touch screen with an embedded web browser is easy to use and fully customisable. You can conveniently tailor settings and automate workflows – including integration of third-party solutions. The user interface, which reflects the bold new look of the new e-STUDIO series, enables simple operation and improved efficiency.

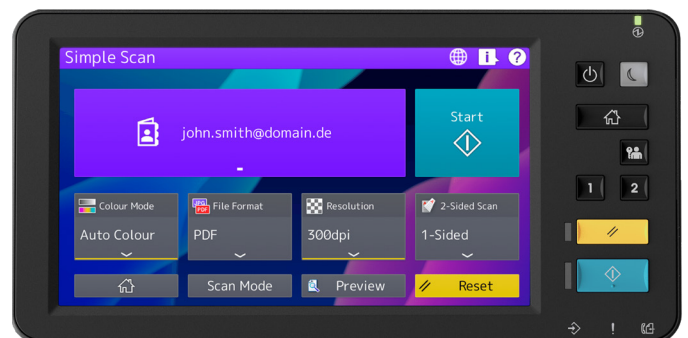
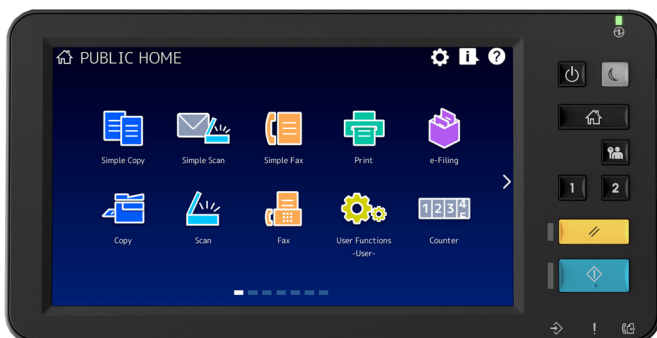

# An All-Rounder for High Demands

Success in today's business world demands seamless access to data and information at all times, regardless of whether staff members are working remotely or on the go. The e-STUDIO9029A series easily integrates into cloud and mobile workflows. Thanks to the advanced e-BRIDGE Next controller technology, you can even seamlessly utilise third-party solutions.

The array of embedded apps is designed to address the individual requirements of each business, and gives you the flexibility to connect to the cloud-based application of your choice.

To ensure a perfect fit, contact our team of software developers for support in creating customised apps for you.

## Cloud solution apps

- e-BRIDGE Plus for Box
- e-BRIDGE Plus for Dropbox™
- e-BRIDGE Plus for Google Drive™
- e-BRIDGE Plus for Google Workspace™ Google Drive™
- e-BRIDGE Plus for Gmail™
- e-BRIDGE Plus for OneDrive®
- e-BRIDGE Plus for OneDrive® for Business
- e-BRIDGE Plus for SharePoint® Online
- e-BRIDGE Plus for Exchange Online
- e-BRIDGE Plus for Universal Print

## Workflow solution apps

- e-BRIDGE Plus for Barcode Scan
- e-BRIDGE Plus for USB Storage
- e-BRIDGE Plus for Green Information
- e-BRIDGE Plus for Zone OCR
- e-BRIDGE Plus for ID Card
- e-BRIDGE Plus for Voice Guidance

## Your partner in sustainability

Toshiba is committed to people and the future of our planet. With the aim of building a sustainable society, we make every effort to minimise the impact of our business on the environment. Conservation and protection of the world's natural resources are top priorities in every business process and product. A key aspect of our approach is to provide solutions that make our customers' operations more sustainable. Accordingly, the e-STUDIO9029A series has also been equipped with various environmentally friendly features:

- Low-power, super sleep mode to save money and reduce energy consumption
- Compliant with the latest, most stringent environmental requirements
- The e-BRIDGE Plus for Green Information app, which displays environmental achievements directly on the MFP to encourage use of eco-friendly settings

## Security meets convenience

As a leading provider of information technology, Toshiba has always placed top priority on protecting data. The e-STUDIO9029A series comes with state-of-the-art security features, such as anti-malware function, secure Solid State Drive (SSD) and Trusted Platform Module (TPM) with encryption function. Optionally you can choose the FIPS HDD\* with data overwrite function and HCD-PP \*\* certification. Deploy all the security technologies offered to ensure your data are protected when using the MFP.

\* Federal Information Processing Standards Hard Disc Drive





# Big Performance in Any Work Environment

Toshiba's e-STUDIO09029A series offers a wide spectrum of functionalities in a surprisingly compact format. The multifunctional systems enable you to integrate and simplify your workflows while improving efficiency.

**Reliable High Speeds** include 65/75/90 monochrome pages per minute.

**Mobile printing** gives you full flexibility and lets you easily connect to mobile devices via AirPrint on iOS/ macOS® or the Mopria Print Service.

**Wi-Fi Direct** offers the option of on-demand connection. Coupled with the Toshiba e-BRIDGE Print & Capture app, the feature not only lets you print from but also scan to your mobile device.

**Remote assistance** fits seamlessly into today's workstyles and helps keep your business running when technical difficulties or uncertainties occur.

**Embedded Optical Character Recognition (OCR)** simplifies the creation of searchable PDFs and editable document formats such as Microsoft Word.

**Scan to USB** is great for working with documents on the go. You can even create PDF/A-2 files suitable for long-term archiving.

**Scan and fax preview** allows you to review, rotate and modify your scanned documents or incoming faxes before saving or printing them.

**Barcode printing** lets you send print data from your ERP system directly to the MFP. The barcode sequence is automatically processed and printed with no need for additional middleware.

**Customisable user interface (UI)** for your ideal user experience. A fully customisable, tiltable 26 cm (10.1") colour panel works like a tablet or smartphone interface, so you can find whatever you need with a swipe of your finger.

**Toner Change On-The-Fly** allows you to replace toner cartridges, even while the MFP is printing.



# Configurations

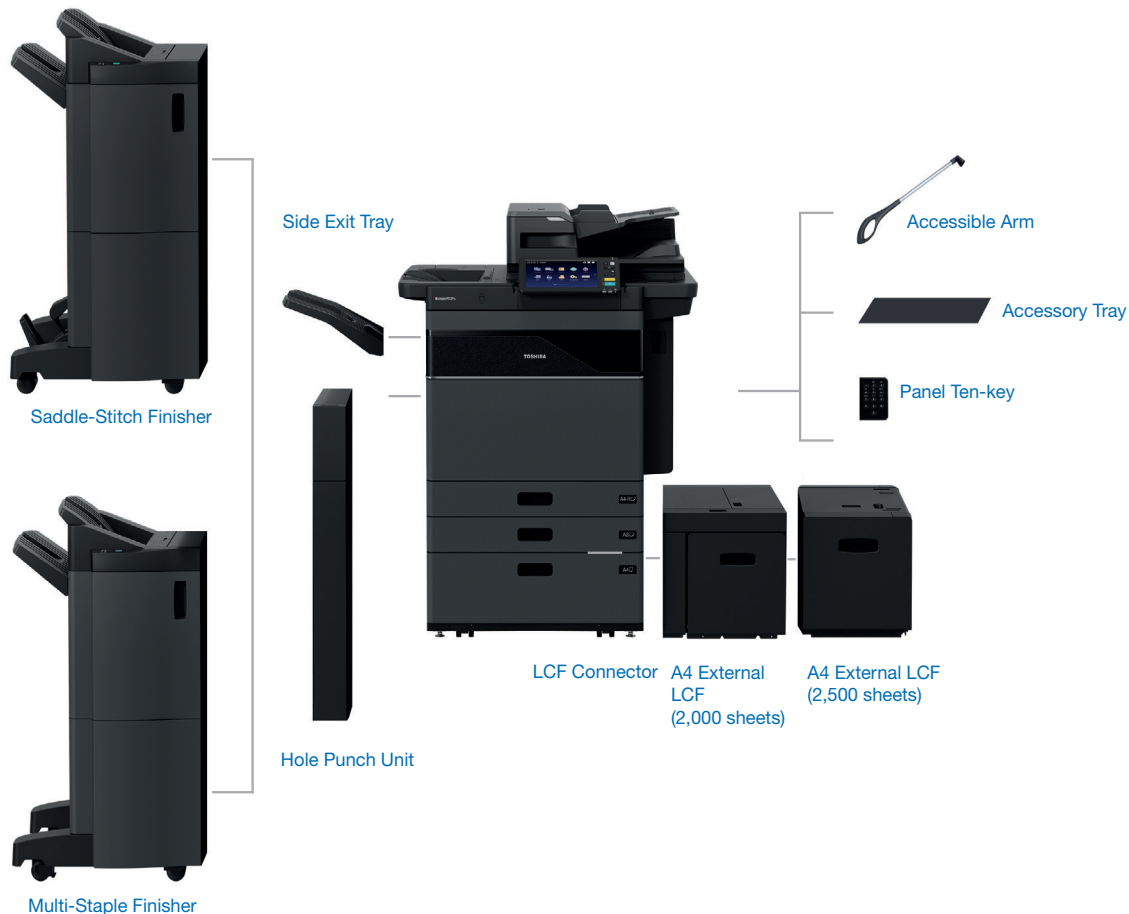

## Highlights

### Embedded apps

Each company has its own needs and preferences for storing and sharing data. To make sure you can use the e-STUDIO9029A series MFPs as you wish, we have made an array of apps available to let you adapt them and enhance your efficiency. By using your choice of embedded and optional apps, you can create the workflow you need and the user experience you wish. Whether connecting to cloud services or local applications, we have the solution.

### Multi-station print solution

Toshiba's proprietary Multi Station Print Solution allows users to send print jobs from their desktops and retrieve

them at up to 50 different MFPs within the network by authenticating at their device, e.g. by simply swiping a badge.

### Dual Scan Document Feeder (DSDF) and Double Feed Detection

The DSDF can hold up to 300 originals and processes 240 pages per minute (ppm) by scanning both sides of the page in a single pass. With the Double Feed Detection, you can ensure that no pages are missing after scanning.

# Specifications

## General

Print & Copy Speed	A4: 65/75/90 ppm A3: 30/37/40 ppm
Warm-up Time	~ 15 seconds from low power mode
Paper Size & Weight	Drawer: A5R-320 x 460 mm, 60-300 g/m <sup>2</sup> Tandem-LCF : A4, 60-300 g/m <sup>2</sup> Bypass: 100 x 148 mm-330 x 483 mm, 60-300 g/m <sup>2</sup> Banner paper (up to 313.4 x 1,200 mm, 90-163 g/m <sup>2</sup> )
Paper Capacity	Drawer: 2 x 540 sheets Tandem-LCF : 1 x 2,320 sheets Bypass: 1 x 120 sheets, Max. 8020 sheets (with optional External LCF)
Automatic Duplex	A5R-A3, 320 x 450, 60-256 g/m <sup>2</sup>
Controller Type	Toshiba e-BRIDGE Next
Control Panel	26 cm (10.1") Multi-Touch Colour Panel
Memory	Security SSD 128 GB ; 6 GB RAM Security HDD 320 GB ; 6 GB RAM (with Option HDD) Security SSD 640 GB ; 6 GB RAM (with Option SSD)
Interface	10Base-T/100Base-TX/1000Base-T, High Speed USB 2.0, WLAN (IEEE802.11a/b/g/n/ac incl. WI-FI direct)/ Bluetooth*
Dimension & Weight	955 x 698 x 1,227 mm (W x D x H), ~193 kg
Initial Consumables	Drum, Developer, Waste Toner Box

## Print

Resolution	600 x 600 dpi, 1 bit, 2,400dpi (Equivalence) x 600dpi (with smoothing), 1,200 x 1,200 dpi, 2 bit (equiv. 3,600 x 1,200 dpi) with PostScript driver only
Page Description Language	PCL5e, PCL5c, PCL6 (PCL XL), XPS, PDF and PS3, (JPEG)
Supported Systems	Windows 11/10, Windows Server 2022/2019/2016/ Server 2012/R2, Mac OS 10.12-13, Linux/Unix, Citrix, SAP, AS-400
Network Protocols	TCP/IP (IPv4/IPv6), Ether Talk, NetBios over TCP/IP
Mobile Printing	e-BRIDGE Print & Capture, Mopria® Print Service, AirPrint®
Print Functions	Universal Printer Driver, Driver Templates, Driver plug-ins*, Print from USB, Hold Print, Tandem Printing, E-Mail direct printing

## Scan

Resolution	Max. 600 x 600 dpi
Scan Speed	Dual Scan Document Feeder: up to 240 ipm (300 dpi) in colour and monochrome
Scan Modes	Auto-Colour (ACS), Colour, Greyscale, Monochrome
File Formats	JPEG, Multi/Single Page TIFF/XPS/PDF, Secure PDF, Slim PDF, PDF/A-1b, PDF/A-2b, Searchable PDF, DOCX, XLSX
Scan Functions	WS Scan, Scan to USB, Scan to E-Mail, Scan to File (SMB, FTP, FTPS, Local), Meta Scan*, OCR scan, Scan to Box (e-Filing), WIA, TWAIN

## Copy

Resolution (Output)	equiv. 2,400 x 600 dpi (with smoothing)
First Copy Output Time	Monochrome: ~ 5.2/4.5/4.1 seconds
Zoom	Platen: 25-400%, DSDf: 25-200 %
Copy Modes	Text/Photo, Text, Photo, Custom
Copy Functions	Rotate Sort, ID Card Copy, Edge Erase, 2-in-1 / 4-in-1 mode

## Fax\*

Communication	Super G3, G3 - (opt. 2 <sup>nd</sup> line) Internet Fax T.37
Transmission Speed	~ 3 seconds per page
Compression	JBIG, MMR, MR, MH
Fax Memory	1 GB Transmission/Reception
Network-Fax	Driver for Windows 11/10, Windows Server 2022/2019/2016/Server 2012 R2/Server 2012 (64bit)
Incoming Fax Routing	To shared folders (SMB, FTP), E-Mail, e-Filing

## System & Security

Device Management	Top Access for remote administration and configuration
System Features	e-Filing document server for secure storage, Document distribution and Print-on-Demand (1 public box, 200 user boxes), over 1,2 million one-touch templates for storage of personalised settings and workflows, Scan/Fax Preview, Rip-while-Print, e-BRIDGE Open Platform, Embedded Web Browser, Job Skip, PCL Barcode printing, e-BRIDGE Plus embedded apps
Accounting & Security	Role Based Access, LDAP support, 1,000 department & 10,000 user codes, Card Reader*, Private Print, Standard data encryption with Toshiba Security SSD, Data Overwrite function when optional HDD is chosen, IP and MAC address filter, Port Filter, Support of SSL and IPsec* protocols, IEEE802.1x support, CC certified (ISO/IEC15408) with HCD-PP v1.0*, Scan to Secure PDF, Pull-printing*

# Options

<b>EXTERNAL LARGE CAPACITY FEEDER</b>	2,500-sheet capacity, A4, 60-300 g/m <sup>2</sup>	<b>HARD DISK DRIVE 320 GB<sup>(1)</sup> (FIPS 140-2 STANDARD)</b>
<b>EXTERNAL LARGE CAPACITY FEEDER</b>	2,000-sheet capacity, A4, 60-300 g/m <sup>2</sup> (in combination with 2500-sheet feeder)	<b>SECURITY SOLID STATE DRIVE 512 GB<sup>(1)</sup></b>
<b>MULTI-STAPLE FINISHER</b>	2 trays, 3,250-sheet capacity, 65-sheet multi-position stapling, A5R-A3, 60-105 g/m <sup>2</sup> (stapling mode)	<b>FAX BOARD</b>
<b>SADDLE STITCH FINISHER</b>	2 trays, 3,250-sheet capacity, Saddle-stitched booklets of up to 60 pages, 65-sheet multi-position stapling, A5R-A3, 60-105 g/m <sup>2</sup> (stapling mode)	<b>USB HUB</b>
<b>HOLE PUNCH UNIT</b>	Available in 2 holes (E), 4 holes (F), 4 holes (S)	<b>ACCESSORY TRAY</b>
		<b>PANEL TEN-KEY OPTION</b>
		<b>WIRELESS LAN/BLUETOOTH MODULE (incl. Wi-Fi Direct)</b>
		<b>RFID MULTI READER</b>
		<b>ACCESSIBLE ARM</b>
		<b>e-SUITE PRINT MANAGEMENT (LICENCE)</b>
		<b>HARD COPY SECURITY KIT (LICENCE)</b>
		<b>META SCAN ENABLER (LICENCE)</b>
		<b>UNICODE FONT ENABLER (LICENCE)</b>
		<b>IPsec ENABLER (LICENCE)</b>



<sup>(1)</sup> 1 GB = 1 billion bytes; the actual formatted capacity is less. Available capacity will also be less if software applications are pre-installed.  
 \* Optional

## About Toshiba TEC

Toshiba TEC Corporation is a leading provider of information technology, operating across multiple industries - ranging from retail, education and business services to hospitality and manufacturing. With headquarters in Japan and over 80 subsidiaries worldwide, Toshiba TEC Corporation helps organisations transform the way they create, record, share, manage and display information.

For more information please contact us:

### Toshiba Tec Malaysia Sdn. Bhd

Registration No.: 198101000677 (66785-D)

No. 5, Jalan Jurubina U1/18, Seksyen U1,

Hicom Glenmarie Industrial Park,

40150 Shah Alam, Selangor Darul Ehsan, Malaysia

Tel : +603-5568 7788 Service : +603-5568 7699 Fax : +603-5568 7700

Website : [www.toshibatec.com.my](http://www.toshibatec.com.my)

### Distributed by



Together Information is Toshiba's vision for how people and organisations create, record, share, manage and display ideas and data.

It is based on our belief that the most successful organisations are those that communicate information in the most efficient way.

We make that possible through an integrated portfolio of industry-specific solutions, all of which reflect Toshiba's commitment to the future of the planet.

