

**TOSHIBA**

## Hybrid MFP

**e-STUDIO3508LP**

**e-STUDIO4508LP**

### Product brochure

---

- > World's first multifunction systems with erasable print function.
- > Unique hybrid printing technology, one single device prints regular as well as reusable prints which saves paper.
- > Equipped with state-of-the-art features for modern document workflows.
- > Designed for businesses which want to combine ecology, economy and efficiency.



**TOGETHER  
INFORMATION**

# OUR BEST TECHNOLOGY TO ENHANCE YOUR BUSINESS

Optimising workflows to get the most out of available resources has become essential for businesses which want to be successful. We have designed our Hybrid MFP to offer you all features you need to be productive and efficient. But there's more: we have added a unique erasable print function, which can be selected in the printer driver just like any other setting.

## Connect

Having access to your documents when you need is getting more and more important. We have made sure you get what you want, whenever you want and wherever you want.

- > **Multi Station Print** allows you to send print jobs from your computer and retrieve them at any convenient MFP by authenticating at that device, e.g. by swiping your badge.
- > **Cloud printing** ensures you have access to your documents no matter where you are. Our embedded apps let you send your documents directly to or print them from Microsoft OneDrive, Google Drive and Dropbox.
- > **Mobile printing** gives you the flexibility to print directly from your mobile device via AirPrint, Google Cloud Print, Mopria Print Service or our Toshiba e-BRIDGE Print & Capture app.

## Integrate

The Hybrid MFP incorporates our latest e-BRIDGE technology. This makes it easy to integrate the system into your existing IT infrastructure and helps the administrators to work more efficiently. The open platform architecture also enables the creation of customised workflows, which simplify complex scanning, archiving or other document management tasks.

## Simplify

We strongly believe that good technology must be easy to use and that's how we designed the Hybrid MFP. The large tablet-like screen with an embedded web browser is easy to use and customisable to meet your needs. It gives direct access to all functions of the MFP and increases the efficiency of the users.

**The world's first Hybrid MFP with erasable print function.**



Toshiba's Hybrid MFP - all features you need in one unique system.

## Reuse

Toshiba's Hybrid MFP comes with a unique feature: paper can be reused thanks to the erasable blue toner, which has a positive impact on the environment. The erasing can be done either via the Hybrid MFP or the optional paper reusing device, the e-STUDIO RD301.



# PRINTING HAS NEVER BEEN THIS GREEN

## How does it work?

Very often we print documents, which are only needed temporary, e.g. to proof-read a document or as a reminder to do something. For these cases Toshiba's hybrid system gives you the possibility to select the erasable blue toner, so that when you don't need your document anymore, you don't have to throw the paper away, but can delete whatever was printed on it and reuse the sheet. To make it easier rule-based printing can be activated in the printer driver. This allows you to define multiple rules for the printer driver to then automatically select the blue toner e.g. for all e-mails and faxes as these type of documents usually tend to be used only temporarily.

To easily track how much you have already saved the e-BRIDGE Paper Reuse Report generates reports which calculate the paper reduction, the average usage of paper etc. to show you your environmental contribution at a glance.

## How can the toner be erased?

The Hybrid MFP itself is capable of erasing the toner. Simply place the used paper into the designated paper cassette and start the process. The blue toner will be erased and you can then place the erased sheets back into the cassette of the MFP to print on it again.

Alternatively, you can use the optional e-STUDIO RD301 - an erasing unit with advanced features. Not only does it erase at a speed of up to 30 ppm, it also sorts the paper into reusable and non-reusable paper. Additionally, it can also digitise the documents for electronic archiving before erasing the toner.

## What is the benefit?

Assuming that you use a sheet of paper five times (i.e. reuse it four times) and you print 4,000 erasable pages per month, you can save 80% paper. This means that after five years, you will have saved almost 200,000 sheets of paper. In other words: The same amount of paper which you would usually use in one year, will now last five years.

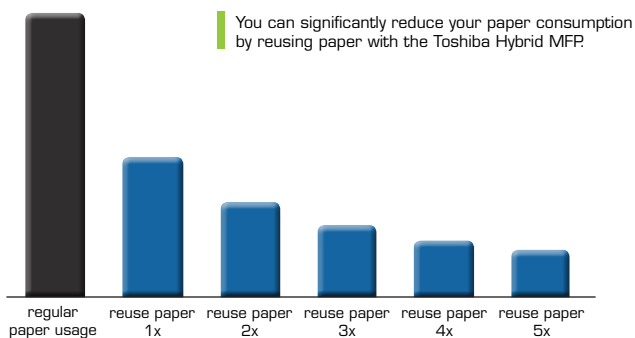

Besides saving costs for paper (purchasing, storage and disposal) there is also a significant environmental benefit as you automatically reduce the carbon emission and water consumption, which is generated during the paper production.

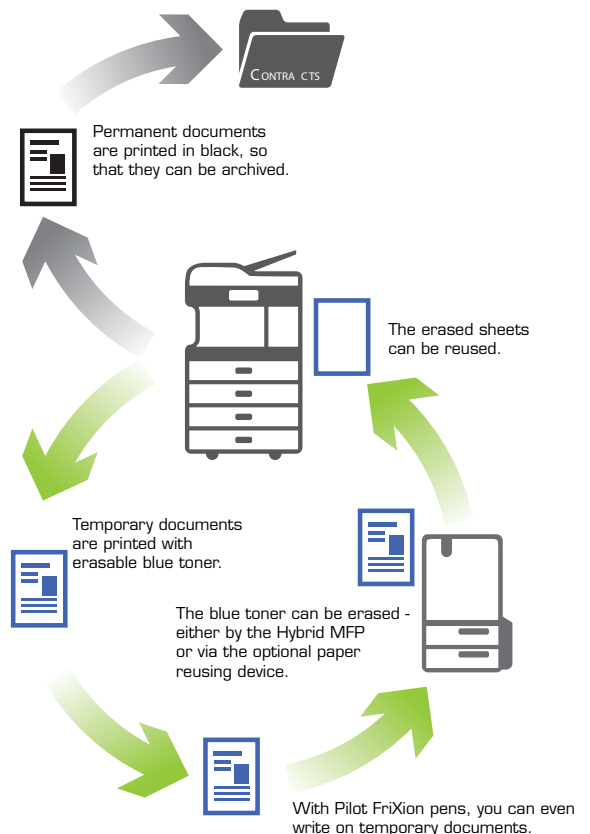

## KEY FEATURES

- > A unique monochrome system with a speed of up to 45 pages per minute (ppm) and up to 35 ppm in erasable blue ensures the Hybrid MFP can handle even large jobs effortlessly.
- > A customisable, tablet-like user interface, gives easy access to the print, scan, copy, fax and erase functions.
- > Utmost data security thanks to features such as the self-encrypting Toshiba Secure HDD and further optional security functions for IEEE2600.2 compliance.

## SPECIFICATIONS

General		Scan	
<b>Print &amp; Copy Speed</b>	Black: 35/45 ppm (A4) Erasable Blue: 35/35 ppm (A4)	<b>Resolution</b>	Maximum 600 x 600 dpi
<b>Erase Speed</b>	Drawers: 17.5 ppm (A4) Bypass: 14.5 ppm (A4)	<b>Scan Speed</b>	Reversing Automatic Document Feeder <sup>9)</sup> : up to 73 ipm (300 dpi) in colour and monochrome Dual Scan Document Feeder <sup>9)</sup> : up to 240 ipm (300 dpi) in colour and monochrome
<b>Warm-up Time</b>	Approx. 22/26/26 seconds from low power mode	<b>Scan Modes</b>	Auto-Colour (ACS), Colour, Greyscale, Monochrome
<b>Paper Size &amp; Weight<sup>1)</sup></b>	Drawers: A5R-A3, 60-256 g/m <sup>2</sup> Bypass: 100 x 148 mm-A3, 60-256 g/m <sup>2</sup>	<b>File Formats</b>	JPEG, Multi/Single Page TIFF/XPS/PDF, Secure PDF, Slim PDF, PDF/A, Searchable PDF <sup>9)</sup> (and other formats like DOCX, XLSX) <sup>9)</sup>
<b>Paper Capacity</b>	2x 550 sheets (Drawers) <sup>2)</sup> , 1x 100 sheets (Bypass) <sup>3)</sup> Maximum 3,200 sheets	<b>Scan Functions</b>	WS Scan, Scan to USB, Scan to E-Mail, Scan to File (SMB, FTP, FTPS, IPX/SPX, Local), Meta Scan <sup>9)</sup> , OCR scan <sup>9)</sup> , Scan to Box (e-Filing), WIA, TWAIN
<b>Inner Output Tray</b> (virgin/reusable paper)	With Bridge Kit: 150/120 sheets Without Bridge Kit: 400/320 sheets	<hr/>	
<b>Automatic Duplex<sup>1)</sup></b>	A5R-A3, 60-256 g/m <sup>2</sup>	<b>Copy</b>	
<b>Controller Type</b>	Toshiba e-BRIDGE Next	<b>Resolution</b>	Scan: 600 x 600 dpi Print: 600 x 600 dpi, 2,400 (equiv.) x 600 dpi with smoothing
<b>Control Panel</b>	22.9 cm (9") Multi-Touch Colour Panel	<b>First Copy Output Time</b>	Black: Approx. 5.9/4.4 Erasable Blue: Approx. 7.8/7.8
<b>Memory</b>	Toshiba Secure HDD 320 GB <sup>4)</sup> , 4 GB RAM	<b>Zoom</b>	25-400% (Platen), 25-200% (RADF/DSDF) <sup>5)</sup>
<b>Interface</b>	10Base-T/100Base-TX/1000Base-T	<b>Copy Modes</b>	Text, Text/Photo, Photo, Blue Original
<b>Dimensions &amp; Weight</b>	585 x 640 x 787 mm (W x D x H), approx. 73 kg	<b>Copy Functions</b>	Electronic Sort, Rotate Sort, ID Card Copy, Edge Erase, 2-in-1 / 4-in-1 mode

## Print

<b>Resolution</b>	600 x 600 dpi, 5 bit, 1,200 x 1,200 dpi, 2 bit (equiv. 3,600 x 1,200 dpi) with PostScript driver
<b>Page Description Language Supported Systems</b>	PCL5e, PCL5c, PCL6 (PCL XL), XPS and PostScript 3 compatible Windows 10/8.1/7/Server 2008 (32/64 bit), Windows Server 2016/Windows Server 2012 Windows Server 2012R2/Server 2008 R2 (64 bit), Mac OS X 10.6.8-10.12, Linux/Unix, Citrix, Novell SLES, SAP, AS/400
<b>Network Protocols</b>	TCP/IP (IPv4/IPv6), IPX/SPX, EtherTalk, NetBios over TCP/IP
<b>Toner Modes</b>	Erasable Blue, Black
<b>Mobile Printing</b>	e-BRIDGE Print & Capture, AirPrint, Mopria Print Service, Google Cloud Print
<b>Print Functions</b>	Universal Printer Driver, Driver Templates, Driver plug-ins <sup>6)</sup> , Print from USB, Hold print, Tandem printing

<sup>1)</sup> Paper weight for Erasable Blue mode: 64-80 g/m<sup>2</sup>.

<sup>2)</sup> If drawer is used for reusable paper, paper capacity of drawer is max. 400 sheets.

<sup>3)</sup> If bypass is used for reusable paper, paper capacity of bypass is max. 30 sheets.

<sup>4)</sup> 1 GB = 1 billion bytes; the actual formatted capacity is less. Available capacity will also be less if software applications are pre-installed.

<sup>5)</sup> Optional

<sup>6)</sup> Finishing functions are not available when printing in Erasable Blue. Paper capacity for reusable paper differs.

## Fax<sup>5)</sup>

<b>Communication</b>	Super G3, G3 - (opt. 2 <sup>nd</sup> line), Internet Fax T.37
<b>Transmission Speed</b>	Approx. 3 seconds per page
<b>Compression</b>	JBIG, MMR, MR, MH
<b>Fax Memory</b>	1 GB Transmission/Reception
<b>Network-Fax</b>	Driver for Windows 10/8.1/7/Server 2008 (32/64 bit), Windows Server 2016/Windows Server 2012 Windows Server 2012R2/Server 2008 R2 (64 bit),
<b>Incoming Fax Routing</b>	To shared folders (SMB, FTP, IPX/SPX), E-Mail, e-Filing

## Accessories (Options)

<b>e-STUDIO RD 301</b>	Paper Reusing Device to scan, erase and sort 100-sheet capacity (Document feeder) 400-sheet capacity (Re-usable paper drawer) 100-sheet capacity (Rejected paper drawer) A5R-A4R, 64-80 g/m <sup>2</sup>	<b>DESK</b> - MH-5000 <b>ENVELOPE DRAWER</b> - MY-1049 <b>JOB SEPARATOR</b> - MJ-5015 <b>FAX BOARD</b> - GD-1370 <b>CARD READER</b> (FIPS 140-2 STANDARD) <b>ACCESSORY TRAY</b> - GR-1250 <b>PANEL TEN-KEY OPTION</b> - GR-1260 <b>WORK TRAY</b> - KK-5005 <b>DATA OVERRWRITE ENABLER</b> - GP-1070 <b>IPsec ENABLER</b> - GP-1080 <b>EMBEDDED OCR ENABLER</b> - GS-1080/1085 <b>MULTI STATION PRINT ENABLER</b> - GS-1090/1095 <b>META SCAN ENABLER</b> - GS-1010 <b>UNICODE FONT ENABLER</b> - GS-1007 <b>ACCESSIBLE ARM</b> - KK-2560
<b>REVERSING AUTOMATIC DOCUMENT FEEDER</b> (MR-3031)	300-sheet capacity, A5R-A3, 35-157 g/m <sup>2</sup>	
<b>DUAL SCAN DOCUMENT FEEDER</b> (MR-4000)	550-sheet capacity (1 Drawer), A5R-A3, 60-256 g/m <sup>2</sup>	
<b>PAPER FEED PEDESTAL<sup>12)</sup></b> (KD-1058)	For Paper Feed Pedestal 550-sheet capacity (1 Drawer) A5R-A3, 60-256 g/m <sup>2</sup>	
<b>DRAWER MODULE<sup>12)</sup></b> (MY-1048)	2,000-sheets capacity, A4, 64-105 g/m <sup>2</sup> Not for reusable paper 2 trays, 600-sheet capacity 50-sheet multi-position stapling B5-A3, 60-105 g/m <sup>2</sup> (stapling mode)	
<b>LARGE CAPACITY FEEDER</b> (KD-1059)	2 trays, 2,250-sheet capacity 50-sheet multi-position stapling B5-A3, 60-105 g/m <sup>2</sup> (stapling mode)	
<b>INNER FINISHER<sup>9)</sup></b> (MJ-1042)	2 trays, 3,250-sheet capacity 50-sheet multi-position stapling 5-sheet center folding Saddle-stitched booklets of up to 60 pages B5-A3, 60-105 g/m <sup>2</sup> (stapling mode) Available in 2 holes (MJ1109 & MJ1110)	
<b>MULTI STAPLE FINISHER<sup>9)</sup></b> (MJ-1109)	Available in 2 holes (MJ1042) -	
<b>SADDLE-STITCH FINISHER<sup>9)</sup></b> (MJ-1110)	Available in 2 holes (MJ1042) -	
<b>HOLE PUNCH UNIT<sup>9)</sup></b> (MJ-6105)	Available in 2 holes (MJ1042) -	
<b>HOLE PUNCH UNIT<sup>9)</sup></b> (MJ-6011)	Available in 2 holes (MJ1042) -	



This is Class 1 laser product complying with IEC60825-1.

Windows is a registered trademark of Microsoft Corporation in the United States and other countries. iPad, iPhone, iPod, and iPod touch are trademarks of Apple Inc., registered in the U.S. and other countries. AirPrint and the AirPrint logo are trademarks of Apple Inc. IOS is a registered trademark of Cisco in the United States and other countries and is used under license. Android is a trademark of Google Inc. All other brand and/or product names are trademarks of their respective owners. Mention of third party products herein is for informational purposes only.

This brochure was compiled based on information that was accurate prior to product launch. Product design and specifications are subject to change without notice. The colour(s) of the actual product may vary from the colour(s) shown in this brochure. No part of this material may be used or reproduced in any manner whatsoever without permission. 1GB is equivalent to 1 billion bytes. Warm-up time and print speed may vary depending on the operating environment. ©2017 TOSHIBA TEC.

As an ENERGY STAR Partner TOSHIBA TEC CORPORATION has determined that this multifunctional device model meets the ENERGY STAR guidelines for energy efficiency.

All company and/or product names are trademarks and/or registered trademarks of their respective owners. All features and specifications described in this brochure are subject to change without notice.  
©2017 TOSHIBA TEC. All rights reserved.

Hybrid MFP - 20170424

For more information, please call or visit us at

# TOSHIBA

**Toshiba Tec Malaysia Sdn. Bhd.**

Registration No.: 198101000677 (66785-D)

4, Jalan Saudagar U1/16, Seksyen U1, Hicom Glenmarie Industrial Park,  
40150, Shah Alam, Selangor Darul Ehsan, Malaysia.  
(P.O. Box 7722, Pejabat Pos Besar,  
40724 Shah Alam, Selangor Darul Ehsan, Malaysia.)

Tel : +603-5568 7788 Service : +603-5568 7699 Fax : +603-5568 7700

Website : www.toshibatec.com.my